

IEC交流充电插座 IEC AC charging socket

型号 Model: □V2-DSIEC2a-G-EV16S □V2-DSIEC2a-G-EV32S

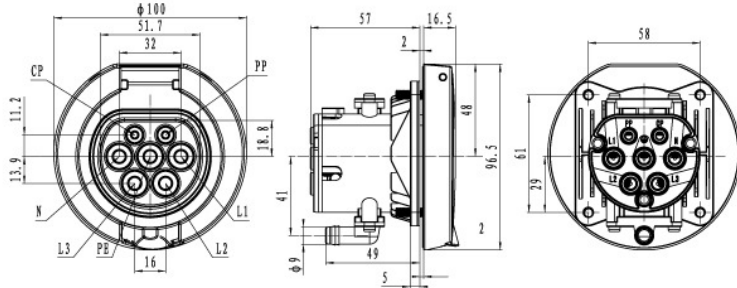

快速代码 Speed code: 2040



产品应用: 充电桩端电连接输入

Product application: Charging pile electrical connection

产品特点 /Features

- 符合62196-2 IEC 2010 SHEET 2-IIa标准
Meet 62196-2 IEC 2010 SHEET 2-IIa standard
- 外形美观, 上翻盖防护, 支持前安装方式。
Nice appearance, up flip protection, support front installation
- 可靠性材料, 阻燃、耐压、耐磨、耐冲击、高抗油。
Reliability of materials, antiframping, pressure-resistant, abrasion resistance, impact resistance and high oil.
- 优越防护性能, 防护等级达到IP44 (工作状态)
Excellent protection performance, protection grade IP44 (working condition)

机械性能 /Mechanical properties

- 机械寿命: 空载拔插 > 5000次
Mechanical life: no-load plug in/pull out > 5000 times
- 耦合时插拔力: > 45N < 80N
Coupled insertion force: > 45N < 80N

电气性能 /Electrical Performance

- 额定工作电流: 16A或32A
Rated current: 16A or 32A
- 工作电压: 250/415V
Operating voltage: 250/415V
- 绝缘电阻: > 1000MΩ (DC500V)
Insulation resistance: > 1000MΩ (DC500V)
- 端子温升: < 50K
Terminal temperature rise: < 50K
- 耐压: 2000V
Withstand voltage: 2000V
- 接触阻抗: 0.5mΩ Max
Contact Resistance: 0.5mΩ Max

材料应用 /Applied Materials

- 外壳材料: 热塑性塑料, 阻燃等级UL94 V-0
Case Material: Thermoplastic, flame retardant grade UL94-0
- 插套: 铜合金, 表面镀银
Contact bush: copper alloy, silver plating

环境性能 /Environmental performance

- 工作环境温度: -30℃ ~ +50℃
Operating temperature: -30℃ ~ +50℃

产品选型与标准配线 Model selection and the standard wiring

型号 / Model	额定电流 / Rated current	线缆规格 / Cable specification
V2-DSIEC2a-G-EV16S	16A单相 / Single phase	3 × 2.5mm ² +2 × 0.75mm ²
	16A三相 / Three phase	5 × 2.5mm ² +2 × 0.75mm ²
V2-DSIEC2a-G-EV32S	32A单相 / Single phase	3 × 6mm ² +2 × 0.75mm ²
	32A三相 / Three phase	5 × 6mm ² +2 × 0.75mm ²