

EMUS BMS Cell Module 72Ah

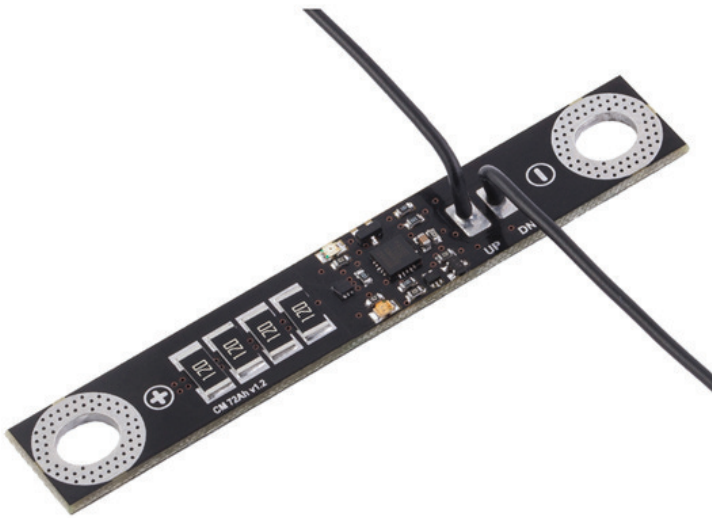

Dimensions

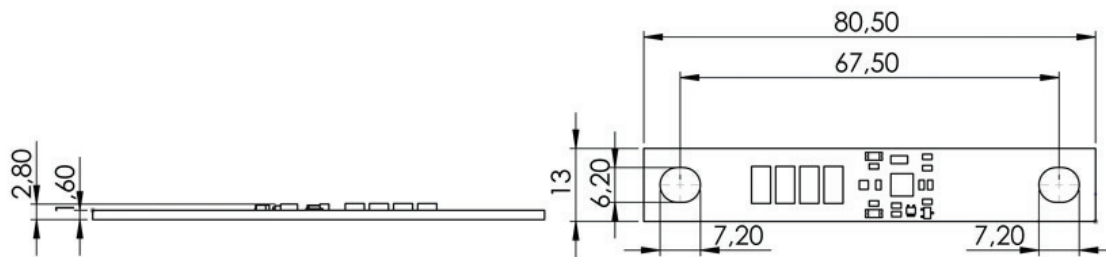

Description

Emus BMS Cell Modules are the single cell controllers that measure cell voltage and provide means of controlled dissipative balancing. Each Cell Module can also measure its own temperature, and is equipped with a special serial interface for communication with the main controller.

Application

The 72Ah model is designed specifically for CALB CAM72AH cell (LiFePO4 chemistry).

Specifications

- Shunt characteristics:
 - $R_{TOT} = 3\Omega$;
 - $P_{MAX} = 2W$;
- Max balancing current: 1.15A (limited by P_{MAX});
- Operating voltage: 2.0V÷4.55V;
- Operating temp.: -40°C ÷ +80°C;
- Voltage measurement accuracy: $\pm 10mV$;
- Temperature measurement accuracy: $\pm 5^\circ C$;
- Dimensions: 80.5x13x2.5 mm;
- Wire lenght: 100mm;
- Mounting hole: M7.2.

Product information

EMUS BMS Cell Module 72Ah

Part number

CM060A